

Super Bright H15 LED Headlight Bulbs 10000LM Canbus Error Free High Beam and DRL 12V 24V for Auto Headlight Kit

Our Product Introduction

for more products please visit us on automotive-ledlight.com

Basic Information

- Place of Origin: Guangdong, China
- Brand Name: HAOHIGH
- Certification: ce
- Model Number: H15
- Minimum Order Quantity: 20 sets
- Price: \$7.12 - \$8.70/sets
- Packaging Details: in box
- Delivery Time: 30 days
- Payment Terms: T/T, Western Union
- Supply Ability: 10000 Piece per Month



Product Specification

- Year: Universal
- Model: H15
- OE No.: H15
- Voltage: 9V-18V
- Warranty: 1 Year
- Product Name: H7 H4 H11 H8 9012 Car LED Headlight Bulb Pur
- Power: 60W
- LED Chip: 5530
- Lumen: 6000 Lm
- Color Temperature: 6000K
- Lifespan: 30000hrs



More Images

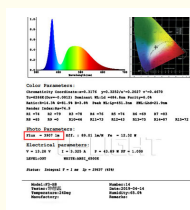

Our Product Introduction

Product Description

Mini E2 Led Car Headlights Bulb Automotive Lighting System H4 H7 H11 9005 9006 Auto head lamp light plug and play

Product Description

Item No.	Mini E2 Led Car Headlights Bulb
Base Type	Aviation aluminum
Available Colors	White
Led Chips	5530
Voltage	9V-18V
Lumens	6000lm
Power	60W
Color temperature	6000K
Warranty	1 Year
Packing	color box packing
Life	>30000hrs
Waterproof rate	IP68

F3 LED CAR HEADLIGHT

INTELLIGENT COOLING SYSTEM WITH DUAL BALL FAN + vacuum liquid conduction



Vacuum liquid conduction system. Rapid conduction heat by 10000w/m.k vacuum liquid.



Intelligent cooling system with dual ball fan

Reduce lighting decay and ensure stability by latest.

LANSEKO U-LIGHT

F3 LED Headlight



10000LM



Special for Automobile



Dual-ball Cooling Fan



>HID



High Power



Intelligent Temperature Control System

Wide beam angle to ensure driving safety

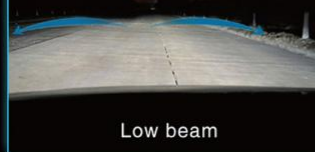

Low beam

Long beam distance, enhance 30% brightness than HID



High beam

www.lanseko.com / www.ulightcn.com



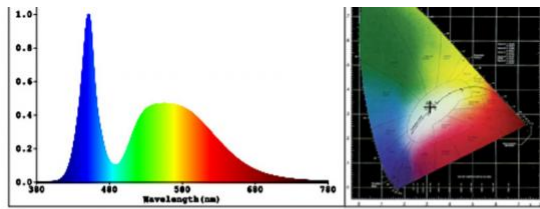

Color Parameters:

Chromaticity Coordinate: $x=0.3176$ $y=0.3252$ $u'=-0.2027$ $v'=0.4670$
To=6266K(Duv=-0.0012) Dominant WL: $\lambda_d=484.8\text{nm}$ Purity=6.0%
Ratio: R=14.3% G=81.9% B=3.8% Peak WL: $\lambda_p=451.3\text{nm}$ HWL: $\lambda_{hd}=21.9\text{nm}$
Render Index: Ra=74.9
R1 =74 R2 =79 R3 =78 R4 =76 R5 =74 R6 =69 R7 =83
R8 =65 R9 =0 R10=46 R11=73 R12=43 R13=75 R14=87 R15=72

Photo Parameters:

Flux = 3907 lm Eff. : 89.01 lm/W $P_e = 12.32\text{ W}$

Electrical parameters:

V = 13.20 V I = 3.325 A P = 43.89 W PF = 1.000

LEVEL:OUT WHITE:ANSI_6500K

Status: Integral T = 1 ms $I_p = 29637$ (45%)

Model:F3-R8
Tester:
Temperature:24Deg
Manufacture:

Number:14
Date:2019-04-14
Humidity:65.0%
Remarks:

F3 EXCEED HID

10000LM

The product is a red and black HID headlight assembly. The red section features a circuit board pattern and a central yellow LED chip. The black section is the mounting bracket. The background is a dark blue gradient with light effects.

Special for Automobile

>HID

High Power

Wide beam angle to ensure driving safety

Low beam

Long beam distance, enhance 30% brightness than HID

High beam

A detailed view of the HID headlight assembly, showing the red and black components and the mounting bracket.

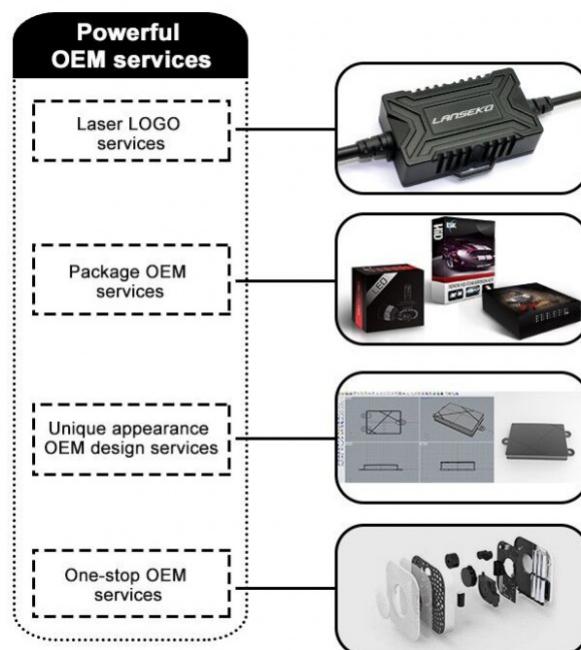



HOW TO TAKE PICTURES

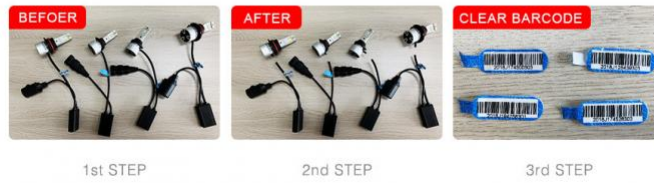

Injection molding workshop



CNC machining workshop



Our production line



FACTORY & TRADING SHOW



Production Line

Aging Test

Production Line



CNC Center

Production Line

Appearance Check



Packaging





FACTORY SHOW



CERTIFICATE



HAOHI HAOHI CO., LTD

☎ 15813693852

✉ hedva511@163.com

🌐 automotive-ledlight.com

Room 803, Chevalier House, 45-51 Chatham Road South, Tsim Sha Tsui, Kowloon, Hong Kong.