

Dual Row LED Light Bar For Car 200W - 1000W Aluminum Profile

Our Product Introduction

for more products please visit us on automotive-ledlight.com

Basic Information

- Place of Origin: China
- Brand Name: Dalilah
- Certification: ce
- Model Number: B-180W
- Minimum Order Quantity: 100 pieces
- Price: \$6.28 - \$8.86/ piece (2 piece/pieces (Min. order))
- Packaging Details: 1 pc/box 24X9X4 cm 0.400 kg
- Delivery Time: 20 days



Product Specification

- Warranty: 1 Years
- Length: DC 24V
- Operating Temperature: 20W
- Application: Off-road/Fog Light/Driving Light/Bar Light
- Led Chip: Os-ram Or Cr-ee
- Color Temperature: 20W
- Material: 6063 Aviation Aluminum
- Beam Pattern: Spot/Flood
- Highlight: Aluminum 6063 Dual Row LED Light Bar, LED Light Bar For Car 200W, LED Light Bar For Car 1000W

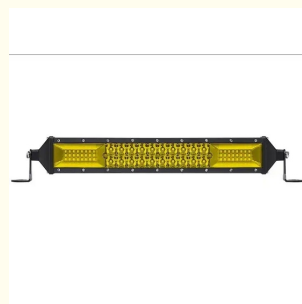

More Images

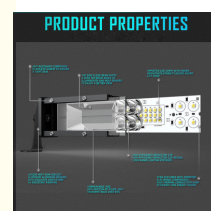
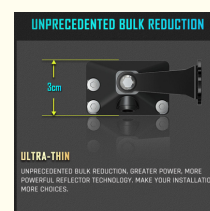
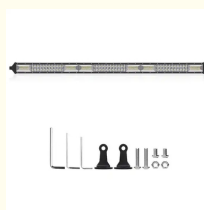

Product Description

Product Description:

Our Amber LED Light Bar is made of high-grade 6063 Aviation Aluminum, and has an impressive lumen output of up to 30000, with power range from 9-36V. It can operate in extreme temperatures ranging from -40°C To +85°C, making it perfect for a wide variety of off-road, fog light, driving light, and bar light applications. With its robust construction and superior light output, this Amber LED Light Bar is the ideal choice for any lighting project.

Our Product Introduction

for

284
mm



539
mm



794
mm



1049
mm



1304
mm



HEAT SINK DESIGN

New aviation aluminum material, while reducing the thickness, heat dissipation function remains unchanged.

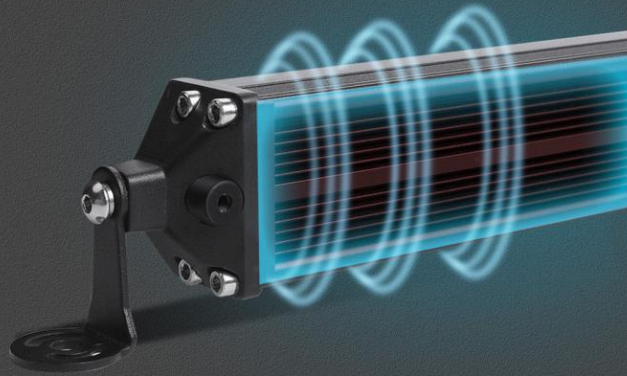

WHY CHOOSE US



FAMOUS CHIPS
Reflector Cup with Projections Chips is better than flat cheap chips in the market.

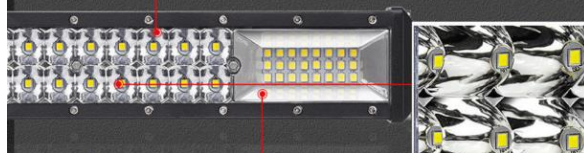

CROSS DESIGN make the light stronger.



BIGGEST REFLECTOR CUP DESIGN
MAKES THE LIGHT WIDER

CONVENTIONAL INSTALLATION POSITION

AVAILABLE IN A WIDE RANGE OF LENGTHS AND CONFIGURATIONS, OUR FLAGSHIP IS THE LIGHT BAR OF CHOICE FOR EVERYTHING FROM LIGHT TRUCK / CAR APPLICATIONS AND VEHICLE RACE TEAMS TO FARMING EQUIPMENT AND POLICE / FIRE RESCUE VEHICLES.



IP68 WATERPROOF

HIGH TRANSMITTANCE COMPRESSION-
RESISTANT SHOCK PROOF PC LENS
EXCELLENT BUILD FOR LONG LASTING



IP68
Waterproof



SHOW RESULTS

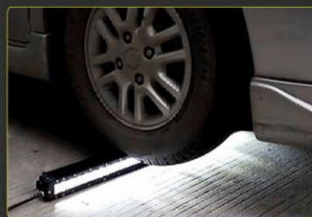

PRODUCT PROPERTIES

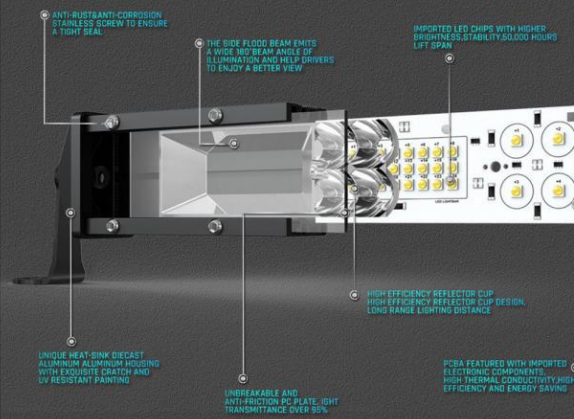

UNPRECEDENTED BULK REDUCTION



ULTRA-THIN

UNPRECEDENTED BULK REDUCTION, GREATER POWER, MORE POWERFUL REFLECTOR TECHNOLOGY. MAKE YOUR INSTALLATION MORE CHOICES.

UNPRECEDENTED BULK REDUCTION



ULTRA-THIN

UNPRECEDENTED BULK REDUCTION, GREATER POWER, MORE POWERFUL REFLECTOR TECHNOLOGY. MAKE YOUR INSTALLATION MORE CHOICES.

FREE WIND NOISE

DECIBEL VALUE

A WHISPER IN THE EAR 20~40dB

NORMAL CONVERSATION 40~60dB

NOISY 60~70dB

VERY NOSIY, HEARING LOSS 70~90dB

CAUSING GREAT DAMAGE TO HEARING 100dB





Features:

Product Name: Amber LED Light Bar, Dual Row LED Light Bar, Double Row Led Light Bar
 Lighting Type: LED
 Operating Temperature: -40°C To +85°C
 Power: 9-36V
 Length: Available From 8"-51"
 Led chip: Os-ram Or Cr-ee

Technical Parameters:

Parameter	Value
IP Rating	IP67
Material	6063 Aviation Aluminum
Lumens	3000-30000
Length	Available From 8"-51"
Operating Temperature	-40°C To +85°C
Lighting Type	LED
Led chip	Os-ram Or Cr-ee
Color Temperature	6500K
Lifespan	50,000 Hours
Power	9-36V
Style	Double Row Led Light Bar, Dual Row LED Light Bar, Dual Row LED Light Bar

Applications:

Dalilah B-180W Double Row LED Light Bar is made of 6063 aviation aluminum and features an IP67 rating to ensure its long-term durability. It is powered by Os-ram or Cr-ee LED chip, and it has a lifespan of up to 50,000 hours. This Dual Row LED Light Bar is perfect for both indoor and outdoor lighting applications, making it ideal for commercial, industrial, and residential use. With its 1-year warranty, you can rest assured that your purchase is covered and you are getting the best value for your money. With its superior illumination and high-quality construction, the Dalilah B-180W LED Light Bar is the perfect choice for your lighting needs.

Customization:

Customize your **Dual Row LED Light Bar**, **Amber LED Light Bar**, **Amber LED Light Bar** and **Spot Flood Combo Light Bar** from Dalilah. Our product has the following features:

Brand Name: Dalilah
 Model Number: B-180W
 Place of Origin: China
 Length: Available From 8"-51"
 Application: Off-road/Fog Light/Driving Light/Bar Light
 Lumens: 3000-30000
 Lifespan: 50,000 Hours
 Power: 9-36V

Support and Services:

We provide technical support and services for our LED light bar products. Our technicians are available to answer any questions about installation, troubleshooting, and maintenance. We are also available to assist with product customization and modifications. We provide detailed documentation and instructions to ensure that our customers get the most out of their LED light bar.

Packing and Shipping:

Packaging and Shipping for LED Light Bar:
 The LED light bar will be packaged in a sturdy cardboard box lined with protective foam. This box will be sealed and labeled with the product description and customer's address. We will ship the LED light bar through a reliable courier service. The transit time will depend on the customer's location and selected delivery method.

FAQ:

Q1: What is the brand name of the LED Light Bar?
 A1: The brand name of the LED Light Bar is Dalilah.
 Q2: What is the model number of the LED Light Bar?
 A2: The model number of the LED Light Bar is B-180W.
 Q3: Where is the LED Light Bar manufactured?
 A3: The LED Light Bar is manufactured in China.
 Q4: What type of light does the LED Light Bar produce?
 A4: The LED Light Bar produces a bright and energy-efficient light.
 Q5: How long does the LED Light Bar last?
 A5: The LED Light Bar is designed to last up to 50,000 hours.

HAOHI HAOHI CO., LTD



15813693852



hedva511@163.com



automotive-ledlight.com

Room 803, Chevalier House, 45-51 Chatham Road South, Tsim Sha Tsui, Kowloon, Hong Kong.